

Type:

Job:

Fixture Catalog number:

Fixture and Finish

Mounting Options:

Ordered Separately from Fixture
 See page 2

Approvals:

Date:
 Page: 1 of 2

Specifications

Top and Husk: Interlocking die-cast aluminum sections drawn together with four concealed stainless steel screws.

Globe: Heat resistant diffuse-coated glass with silicone gasket.

Support Shaft: 1⁵/₈" diameter extruded aluminum with 1/2" NPSM brass nipples plus solid brass locknut for mounting.

Socket: G4 to GY6.35 socket for bipin lamp.

Wiring: 3' No. 18-2 12 Volt cable with fork connectors.

Finish: Super TGIC thermoset polyester powder coat paint, 2.5 mil nominal thickness, applied over a chromate conversion coating; 2500 hour salt spray test endurance rating. Standard colors are Black (**BL**), Dark Bronze (**DB**), and Verde Green (**GR**).

Certification: UL Listed to U.S. and Canadian safety standards for wet locations. Fixture manufacturer shall employ a quality program that is certified to meet the ISO 9001:2000 standard.

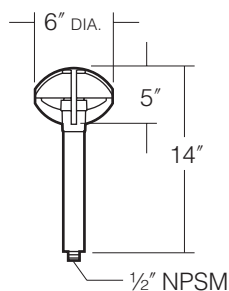

ORDERING INFORMATION

Fixture*

- KLV101BL**
- KLV101DB**
- KLV101GR**

Finish

Black
 Dark Bronze
 Verde Green

Wattage / Lamp

20W - 35W
 T-3 or T-4 Bipin
 Halogen

*Remote transformer required.

Type:
 Job:



Mounting Options

Ordered Separately from Fixture

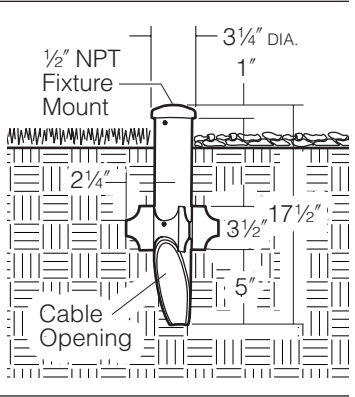
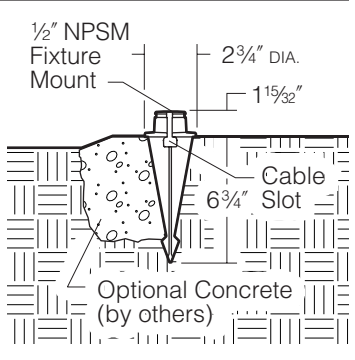
<p>PowerPost™ by Engineered Products Co. Cat. No. <input type="checkbox"/> EP17 <input type="checkbox"/> No Option</p>	<p>PVC fixture molded in black with 1/2" NPT mount is corrosion free and UV resistant. Replaces EMT, conduit connectors and weatherproof boxes. 100% shatter resistant against denting and cracking. Angled bottom to eliminate cable congestion. 17 1/2" post length</p>	
<p>Low Voltage Spear Mount Cat. No. Finish <input type="checkbox"/> KLV400BL Black <input type="checkbox"/> KLV400DB Dark Bronze <input type="checkbox"/> KLV400GR Verde Green <input type="checkbox"/> No Option</p>	<p>Die-cast low copper aluminum with 1/2" NPSM fixture mount. Stainless steel set screw locks fixture into mount. Cable slot allows easy fixture mounting before or after installation in ground. Super TGIC powder coat paint over clear anodizing and chromate conversion. Spear Mounting in Concrete In addition to soil mounting, the KLV400 can be installed in a concrete footing for added stability and permanence.</p>	
<p>Extension Module Cat. No. Finish <input type="checkbox"/> KLV415BL Black <input type="checkbox"/> KLV415DB Dark Bronze <input type="checkbox"/> KLV415GR Verde Green <input type="checkbox"/> No Option</p>	<p>For raising fixtures to a height above foliage for efficient and unobstructed operation. Constructed of 1 5/8" diameter extruded aluminum with die-cast ends. 1/2" NPSM female thread on one end, and other end has a 1/2" NPSM solid brass nipple. Stainless steel allen head set screw locks fixture onto mount. Super TGIC powder coat paint over chromate conversion. Two modules may be stacked for additional height.</p>	