



BRASS WALL MOUNT SL-16-D-SERIES (MR16/MR11/MR8)

TYPE

SPECIFICATIONS

- CONSTRUCTION:** Cast brass; cylinder and canopy
- LENS:** Clear tempered flat glass
- CANOPY GASKET:** Black newsponge closed cell .190" thickness
- LAMP SUPPLIED MR16 MODELS:** 20w MR16 FL(BAB); 5000 hours average rating (20w max)
- LAMP SUPPLIED MR11 MODELS:** 20w MR11 FL(FTD); 5000 hours average rating (20w max)
- LAMP SUPPLIED MR8 MODELS:** 20w MR8 FL(23°); 2000 hours average rating (20w max)
- LAMP OPTIONS MR16 MODELS:** We recommend 20w MR16 ULTRA10,000 hours average rating or 4w ARROW LED 50,000 average rating
- LAMP OPTIONS MR11 MODELS:** We recommend 20w MR11 ULTRA10,000 hours average rating or 2w ARROW MR11 LED, 50,000 hours average rating
- LAMP OPTIONS MR8 MODELS:** 1.5w MR8 LED 25,000 hours average rating
- SOCKET:** High temperature ceramic GU5.3 bi-pin, 250°C silicone lead wires
- WIRING:** Black and 2 White 250°C silicone lead wires
- CONNECTION:** FA-05 Quick Connector (not supplied) from fixture to main cable (12/2, 10/2 or 8/2 only)
- MOUNTING:** Canopy included with 2 brass #2 Phillips, flat head, wood screws
- FINISH:** Unfinished brass. Optional finishes available



SL-16-D-MR16-BAV



SL-16-D-MR11-BRS



SL-16-D-MR8-BRS

ORDERING INFORMATION

CATALOG NO.	DESCRIPTION	LAMP	SHIP WEIGHT
SL-16-DMR16-BRS	Brass Down Light	20w MR16 FL(BAB)	2.0 lbs.
SL-16-DMR11-BRS	Brass Down Light	20w MR11 FL(FTD)	2.0 lbs.
SL-16-DMR8-BRS	Brass Down Light	20w MR8 FL	2.0 lbs.

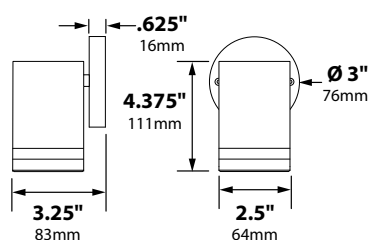

SL-16-D-MR16

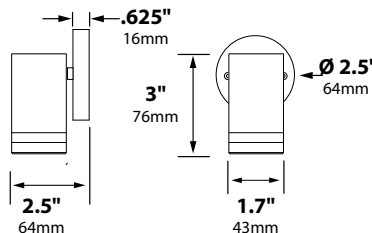

SL-16-D-MR11

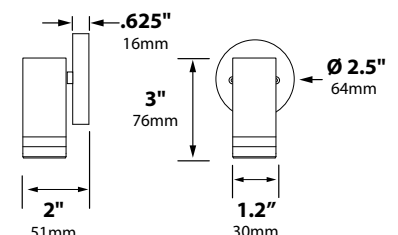

SL-16-D-MR8

COLOR/BEAM/GLARE CONTROL ACCESSORIES

SL-16-D-MR16-BRS

- FA-08-21 Round 1/8" Black Hex Cell Louver
- FA-11-BLUE Blue Tempered Flat Glass Lens
- FA-11-GREEN Green Tempered Flat Glass Lens
- FA-11-AMBER Amber Tempered Flat Glass Lens
- FA-11-RED Red Tempered Flat Glass Lens
- FA-98-36C16 Linear Spread Tempered Glass Lens
- FA-104-SB Wide Spread Sand Blasted Glass Lens

SL-16-D-MR11-BRS

- FA-08-17 Round 1/8" Black Hex Cell Louver
- FA-11-17-BLUE Blue Tempered Flat Glass Lens
- FA-11-17-GREEN Green Tempered Flat Glass Lens
- FA-11-17-AMBER Amber Tempered Flat Glass Lens
- FA-11-17-RED Red Tempered Flat Glass Lens
- FA-98-17 Linear Spread Tempered Glass Lens
- FA-104-17-SB Wide Spread Sand Blasted Glass Lens

SL-16-D-MR8-BRS

- FA-08-23 Round 1/8" Black Hex Cell Louver
- FA-11-23-BLUE Blue Tempered Flat Glass Lens
- FA-11-23-GREEN Green Tempered Flat Glass Lens
- FA-11-23-AMBER Amber Tempered Flat Glass Lens
- FA-11-23-RED Red Tempered Flat Glass Lens
- FA-98-23 Linear Spread Tempered Glass Lens
- FA-104-23-SB Wide Spread Sand Blasted Glass Lens



JOB INFORMATION

Type: _____ Date: _____

Job Name: _____

Cat.No.: _____

Lamp(s): _____

Specifier: _____

Contractor: _____

Notes: _____

FOCUS INDUSTRIES INC. 25301 COMMERCENTRE DRIVE LAKE FOREST, CA 92630
 www.focusindustries.com sales@focusindustries.com (949) 830-1350 • FAX (949) 830-3390

Black Texture (Standard)	Antique Verde	Bronze Texture	Camel	White Texture	Hunter Texture	Rust	Weathered Iron	Weathered Brown	Stucco	Rubbed Verde	Chrome Powder	Acid Rust	Acid Verde	Black Acid Treatment
-BLT	-ATV	-BRT	-CAM	-WTX	-HTX	-RST	-WIR	-WBR	-STU	-RBV	-CPR	-BAR/CAR	-BAV/CAV	-BAT



WALL MOUNT SL-16-D-SERIES (MR16/MR11/MR8)

TYPE

LIGHT DISTRIBUTION AND PHOTOMETRICS

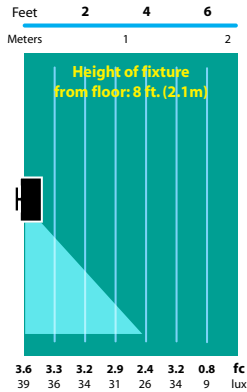

SL-16-D
Light Distribution and Photometrics
6 ft. (1.8m) radius

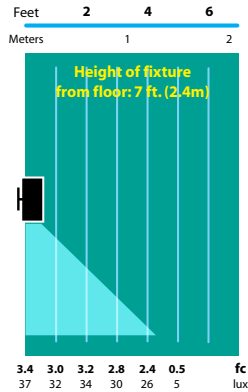

SL-16-D
Light Distribution and Photometrics
5 ft. (1.5m) radius

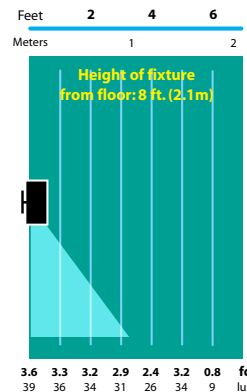

SL-11-D
Light Distribution and Photometrics
6 ft. (1.8m) radius

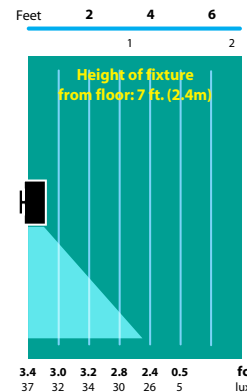

SL-11-D
Light Distribution and Photometrics
5 ft. (1.5m) radius

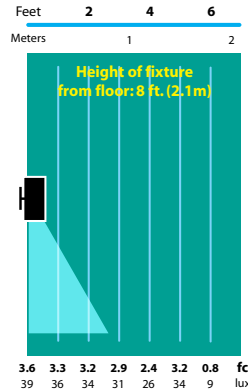

SL-8-D
Light Distribution and Photometrics
6 ft. (1.8m) radius

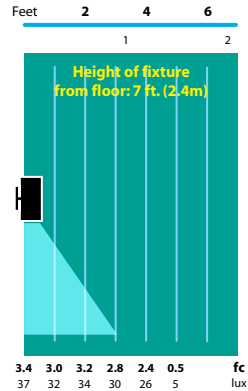

SL-8-D
Light Distribution and Photometrics
5 ft. (1.5m) radius

JOB INFORMATION

Type: _____ Date: _____

Job Name: _____

Cat.No.: _____

Lamp(s): _____

Specifier: _____

Contractor: _____

Notes: _____

FOCUS INDUSTRIES INC.
25301 COMMERCENTRE DRIVE
LAKE FOREST, CA 92630

www.focusindustries.com
sales@focusindustries.com
(949) 830-1350 • FAX (949) 830-3390



Black Texture (Standard)	Antique Verde	Bronze Texture	Camel	White Texture	Hunter Texture	Rust	Weathered Iron	Weathered Brown	Stucco	Rubbed Verde	Chrome Powder	Terra Cotta	Acid Rust	Acid Verde	Black Acid Treatment
-BLT	-ATV	-BRT	-CAM	-WTX	-HTX	-RST	-WIR	-WBR	-STU	-RBV	-CPR	-TRC	-BAR/CAR	-BAV/CAV	-BAT